

# Electrolux

## Upright Vacuum Cleaner Owner's Guide

Household Type

### Z5600 Series

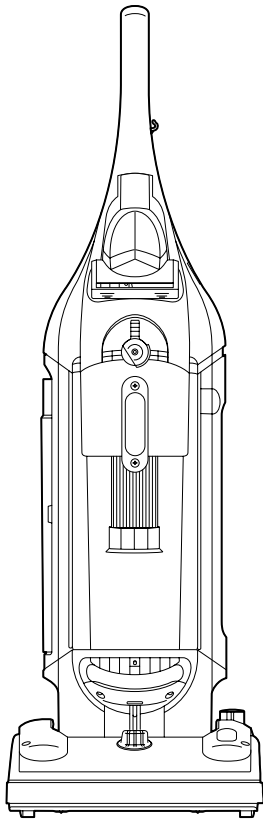

#### **IMPORTANT**

For any advice  
on your cleaner and  
to order filters and  
accessories,  
please telephone the  
Electrolux Helpline on  
**08706 055055**

2 - 4

**IMPORTANT INFORMATION**

4

**GUARANTEE**

5 - 6

**HOW TO ASSEMBLE**

7 - 8

**HOW TO USE**

8

**Thermal Cut Off**

9

**Accessories**

10

**ROUTINE MAINTENANCE**

10

**Hose Blockage**

11 - 12

**Brush Roll**

**Brush Roll Belt**

12 - 13

**Dust Cup**

**Dust Cup Filter**

14

**PERIODIC MAINTENANCE**

14

**Filters**

14

**Riser Visor Turbo Nozzle**

15

**Problem Solving**



*The Electrolux Group.*

# IMPORTANT SAFEGUARDS

When using an electrical appliance, basic precautions should always be followed, including the following:

**READ ALL INSTRUCTIONS BEFORE USING THIS VACUUM CLEANER.**

## WARNING

To reduce the risk of fire, electric shock, or injury:

- Do not use outdoors or on wet surfaces.
- **Do not leave vacuum cleaner when plugged in.** Turn off the switch and unplug the electrical cord when not in use and before servicing.
- Do not allow to be used as a toy. Close attention is necessary when used by or near children.
- Use only as described in this manual. Use only manufacturer's recommended attachments.
- Do not use with damaged cord or plug. If vacuum cleaner is not working as it should, has been dropped, damaged, left outdoors, or dropped into water, have unit serviced before using.
- Do not pull or carry by cord, use cord as a handle, close a door on cord, or pull cord around sharp edges or corners. Do not run vacuum cleaner over cord. Keep cord away from heated surfaces.
- Do not use extension cords or outlets with inadequate current carrying capacity.
- Turn off all controls before unplugging.
- Do not unplug by pulling on cord. To unplug, grasp the plug, not the cord.
- Do not handle plug or vacuum cleaner with wet hands.
- Do not put any object into openings. Do not use with any opening blocked; keep free of dust, lint, hair, and anything that may reduce airflow.
- This vacuum cleaner creates suction and contains a revolving brush roll. Keep hair, loose clothing, fingers, and all parts of body away from openings and moving parts.
- Do not place cleaner on furniture or stairs as the brush roll may cause damage. Place cleaner on floor with the handle in storage position while using attachments.
- Do not pick up anything that is burning or smoking, such as cigarettes, matches, or hot ashes.
- Do not use without dust cup in place.
- Belt pulleys can become hot during normal use. To prevent burns, avoid touching the belt pulley when servicing the drive belt.
- Use extra care when cleaning on stairs.
- Do not use to pick up flammable or combustible liquids such as gasoline, or use in areas where they may be present.
- Store your cleaner indoors in a cool, dry area.
- Keep your work area well lighted.
- Unplug electrical appliances before vacuuming them.

## PLEASE SAVE THESE INSTRUCTIONS

### WARNING

**The brush in the cleaning head rotates at high speed and can cause damage to the mains supply cable if the cleaner passes over it during cleaning operations.**

Care should be taken to ensure that this does not happen. If the cleaning head has accidentally passed over the mains supply cable the following action should be taken:

1. Switch off and remove the plug from the socket outlet.
2. Examine the mains supply cable for damage (only after removing the plug from the socket outlet).
3. If there is any sign of damage to the supply cable it **MUST** be renewed. The repair **MUST** be carried out by an Electrolux Service Agent or a similar qualified person.
4. **NEVER** use the machine with a damaged mains supply cable.

### Proprietary carpet conditioning and air freshening materials

After using proprietary carpet conditioning powders, it is recommended that the filters be changed. Some of these preparations contain substances which if left in the vacuum cleaner for extended periods could damage the plastic mouldings which form the structure of the cleaner.

Many air fresheners, household deodorants, sprays and polishes contain a highly flammable gas propellant.

Because of this, it is particularly important that these products are used strictly in accordance with the relevant manufacturer's instructions.

It is essential that none of the above products are sprayed directly into the vacuum cleaner or any of its filters, hose assembly, or dust cup.

### Thermal Cut Off

This vacuum cleaner has a special thermostat that protects the cleaner in case of motor overheating. If the cleaner switches off, push the switch pedal once and unplug the cleaner. Check the cleaner for a possible source of overheating such as a full dust cup, a blocked hose or clogged filter. If these conditions are found, fix them and wait at least 60 minutes before attempting to use the cleaner. After the 60 minute period, plug the cleaner back in and push the on/off switch On (I). If the cleaner still does not run, please call Electrolux Customer Care on 08706 055 055.

## BEFORE YOU START

### CHECK THE VOLTAGE

Before connecting the cleaner to an electrical supply, ensure that the voltage shown on the rating plate located beneath the cleaner is of the correct voltage for your electricity supply. If it is not, do not use the cleaner but refer back to your dealer.

### CONNECTING TO YOUR ELECTRICITY SUPPLY

Permanently connected to the cleaner is a mains supply (2-core) cable fitted with a non-rewirable plug incorporating a 13A fuse.

In the event of the fuse requiring replacement the fuse cover should be removed using a small screwdriver. The old fuse **MUST** be replaced by a 13A ASTA approved BS1362 fuse or a BSI approved fuse. The cover must be replaced before the plug is used again. In the event of loss of the fuse cover, replacements can be obtained from your Electrolux Retailers and must be of the same colour as indicated by the coloured insert on the base of the plug.

If difficulty is experienced in obtaining a replacement, contact Electrolux Customer Services on 08706 055055.

**In no circumstances must the plug be used without a correct fuse cover fitted.**

If the plug that is fitted to your appliance is not suitable for your socket outlet, it must be cut off and the appropriate plug fitted.

Remove the fuse from the cut off plug.

The cut off plug should then be disposed of to prevent the hazard of shocks in case it should be plugged into a 13 amp socket in another part of your home.

The wires in the mains cable of this appliance are coloured in accordance with the following code: **Blue: Neutral. Brown: Live.**

As the colours of the wires in the mains cable of this appliance may not correspond with the coloured markings identifying the terminals in your plug, proceed as follows:

The wire which is coloured blue must be connected to the terminal which is marked with the letter N or coloured black.

The wire which is coloured brown must be connected to the terminal which is marked with the letter L or coloured red.

If using a three-pin plug, do not make any connection to the terminal marked with the letter E or by the earth symbol or coloured green or green-and-yellow. This cleaner is double insulated and no earth connection is necessary.

It is in your interest to ensure that the plug is correctly attached to the mains cable. In case of doubt, consult a qualified electrician, as Electrolux cannot regard the repair of faults on the plug connection as a service that can be given free of charge under the terms of the guarantee.

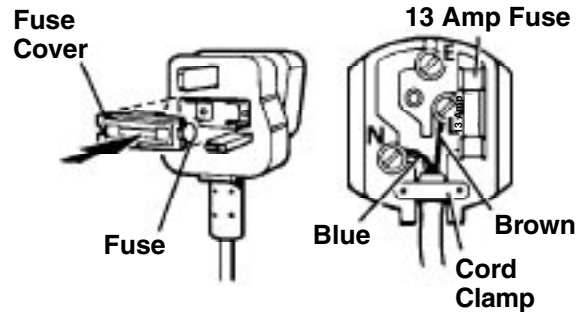

The symbol  on the product or on its packaging indicates that this product may not be treated as household waste. Instead it shall be handed over to the applicable collection point for the recycling of electrical and electronic equipment. By ensuring this product is disposed of correctly, you will help prevent potential negative consequences for the environment and human health, which could otherwise be caused by inappropriate waste handling of this product. For more detailed information about recycling of this product, please contact your local city office, your household waste disposal service or the shop where you purchased the product.

**SERVICE**

Should you require service on your Electrolux cleaner, please telephone Electrolux Customer Services on 08706 055055. Before requesting service, please check whether your problem is covered under Service Checklist (see below).

**New filter pads, brush rollers and drive belts can be obtained from Electrolux Retailers. If difficulty is experienced in obtaining spares, please contact the Electrolux Customer Helpline on 08706 055055.**

**SERVICE CHECKLIST**

- If your cleaner will not operate, check the plug connection, plug fuse and mains fuse.
- **Never allow** the dust cup to become so full that it impedes the air-flow, thus reducing the cleaning efficiency of the machine. The character of household dust and its effect on the air-flow through the machine may vary considerably. Fluffy dust allows air to pass through readily whereas fine powdery dust or proprietary cleaning powders, pack tightly in the dust cup, offering greater resistance to air-flow and will reduce cleaning efficiency if the cup becomes overloaded.
- **Always store** your cleaner and spare dust filters in a dry place.
- **Renew** the filter pads three or four times a year. This is essential to ensure continued high filtration of dust particles.
- **Sucking up** such items as stockings, clippings of cloth, sizeable pieces of paper, wrappings from cigarette packets or sweets etc., may block the hose. **Electrolux regrets that the clearing of blocked hoses cannot be regarded as service that can be given free of charge, under the guarantee.** Should a blockage occur, first disconnect the cleaner from the electricity supply, refer to section headed "Blockages". If these operations are not successful, contact Electrolux on 08706 055055.
- **Never** pick up hot cinders or lighted cigarette ends.
- **Make certain that your cleaner does not come into contact with water or any other liquid. It is not designed as a wet pick up cleaner, and must never be used on damp carpets or wet floors.**

Important - in the event of the mains supply cable of this vacuum cleaner requiring replacement, we recommend that this be carried out by Electrolux Service Staff.

**Spares**

New filters, brush rollers and drive belts can be obtained from Authorised Electrolux Dealers and electrical retailers. If difficulty is experienced in obtaining spares please call us on 08706 055055 or visit our website at [www.shop.electrolux.co.uk](http://www.shop.electrolux.co.uk)

**GUARANTEE**

**This guarantee is in addition to your statutory and other legal rights.**

**This product is for household use only.**

Electrolux products are carefully designed, manufactured, tested and inspected and, in consequence, we undertake to replace or repair any part found to be defective in materials or workmanship, within one year of delivery to the original purchaser, free of charge. You may be required to take the product to your nearest service provider if the product requires attention during the first year.

There are certain conditions which may invalidate this guarantee:

- a. It is dependent upon the appliance being correctly installed and used in accordance with the Company's instructions under normal domestic conditions within the United Kingdom or the Republic of Ireland.
- b. Service at all times must be carried out by an Electrolux Service Representative or authorised agent.
- c. The guarantee may be invalidated by unauthorised repair or modification of the appliance.
- d. You may be charged by Electrolux if you call for an engineer to resolve a problem that we believe is covered in the instruction booklet. (example: blocked/dirty filters)

Electrolux does not accept liability for all defects arising from neglect, misuse or accident. This guarantee excludes such normal wearing parts as drive belts, brushes and filters as the life of these depends upon the amount and nature of use.

Proof of purchase will be required before service under guarantee is provided. Please call 08706 055 055 for assistance.

**IMPORTANT:**

For future reference we suggest you record the following details here, and keep the receipt with the handbook as proof of purchase.

Purchased from \_\_\_\_\_  
 Date purchased \_\_\_\_\_ Model no \_\_\_\_\_



**101 Oakley Road, LUTON, BEDFORDSHIRE, LU4 9QQ**

Features of the Electrolux vacuum cleaner and accessories supplied with it are protected in Great Britain and abroad by Patents or Registered Designs.

This appliance conforms with the requirements of the amended E.E.C. directive No. 89/336/EEC relating to electromagnetic compatibility (EMC) CE.

Electrolux, may introduce modifications to their product from time to time, and consequently the details given in this booklet are subject to alteration without notice.

# How To Assemble

**CAUTION:** Assemble the cleaner completely before plugging into an electrical outlet.

**CAUTION:** Moving parts, stay clear of brush roll when plugging in.

**NOTE:** Features may vary by model yet all parts assemble the same.

## Step A - Remove Dust Cup

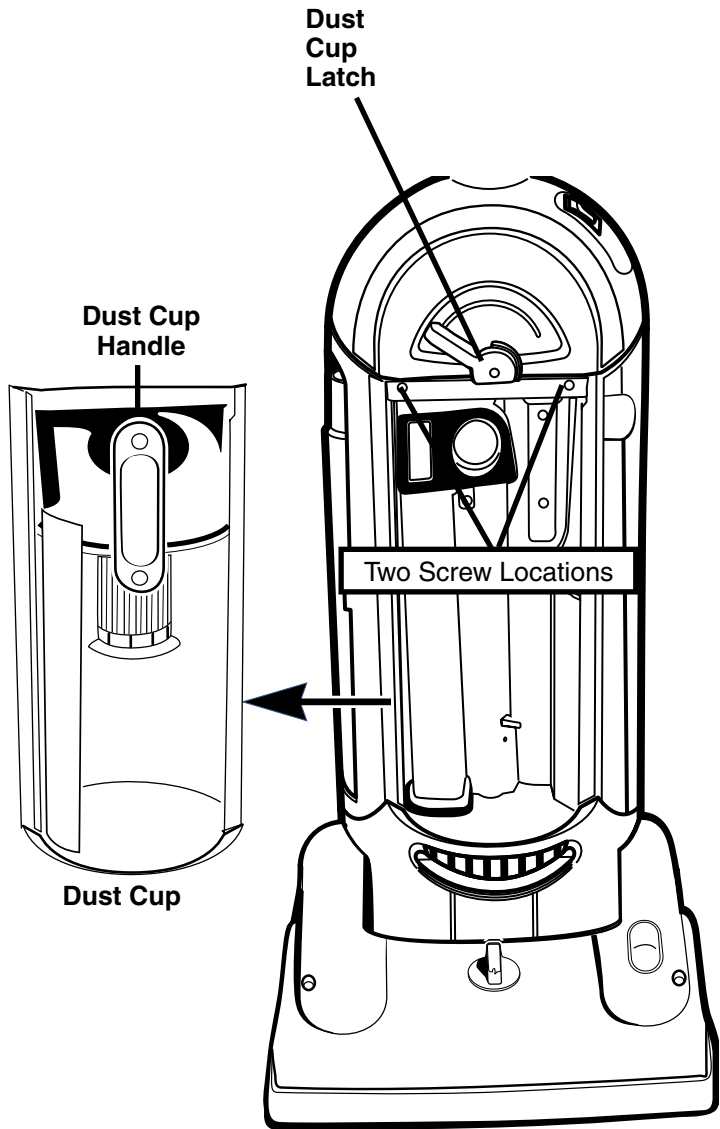

1. Remove dust cup from unit to expose the two screw installation locations. Release the dust cup by rotating the dust cup latch to the left. Pull out and up on the dust cup handle to remove from unit.

## Step B - Attach Handle

**NOTE:** Screws must be installed to properly secure the handle.

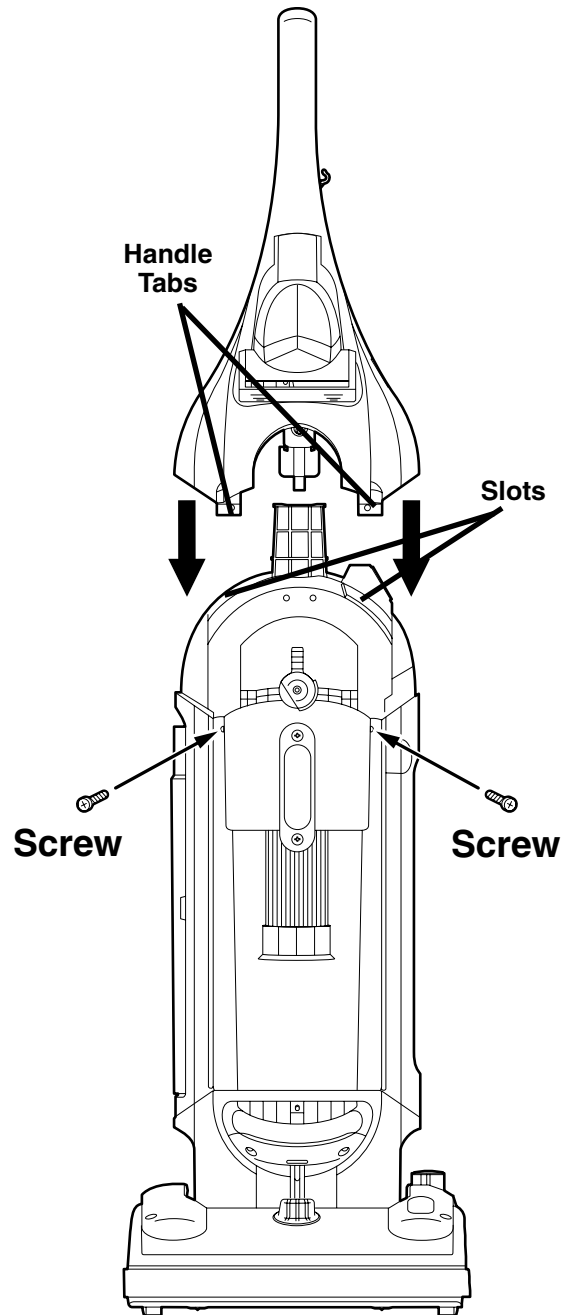

2. Position handle as above. Slide the handle down over the top of the unit, inserting handle tabs into slots on unit.
3. Find the two screws in the accessory bag included in the carton. To secure the handle on the unit, install the two screws.

## Step C - Replace Dust Cup

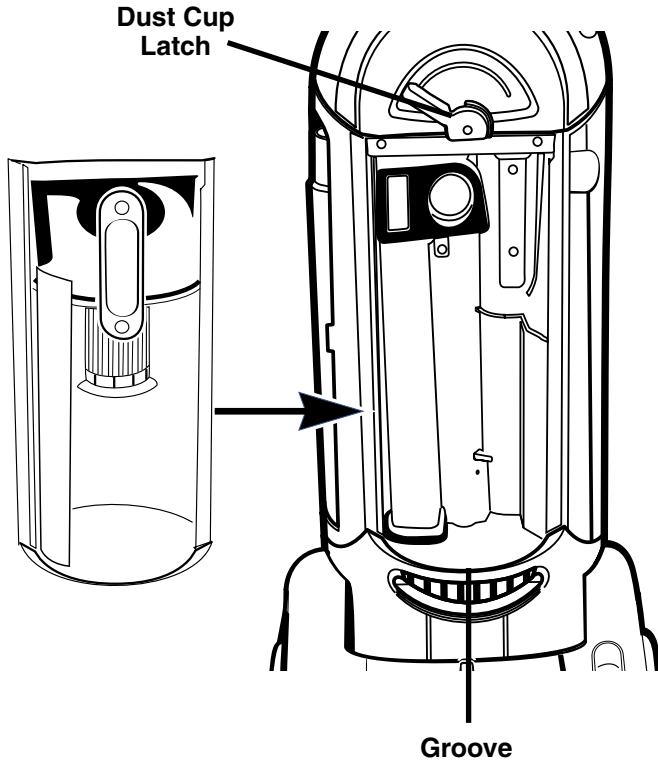

4. Replace dust cup by aligning front of the bottom of dust cup into groove on cleaner. Pivot dust cup up against cleaner and rotate the dust cup latch to the right to secure.

## Step D - Store Accessories

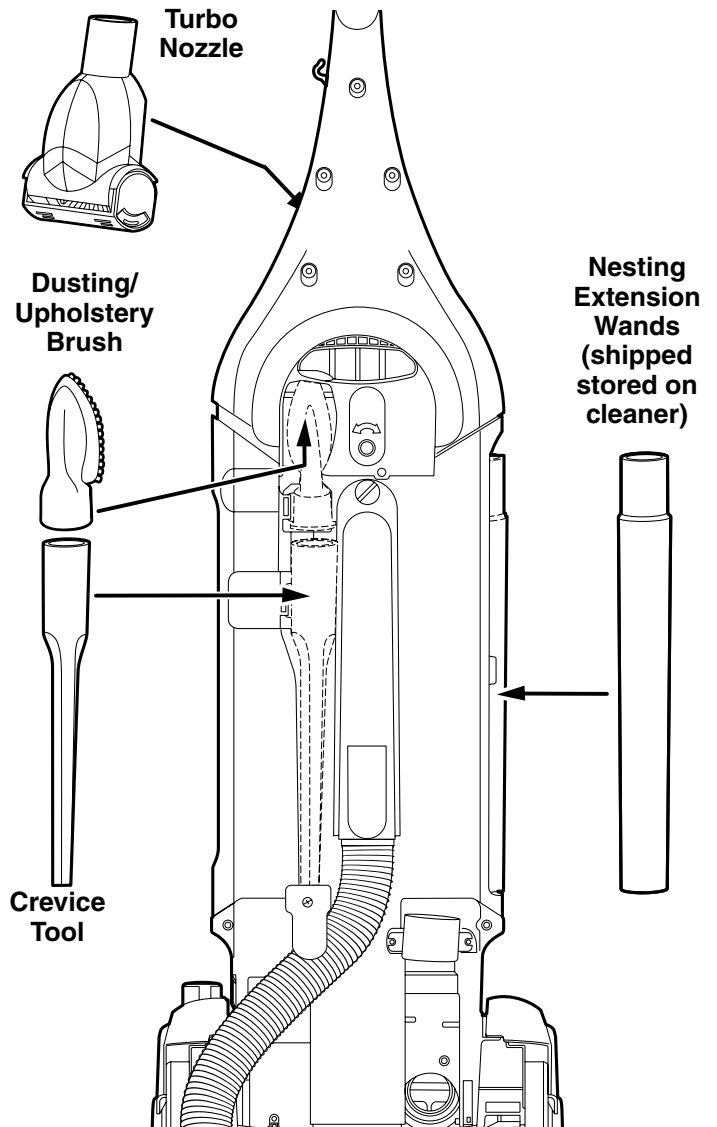

## Step E - Store Electrical Cord

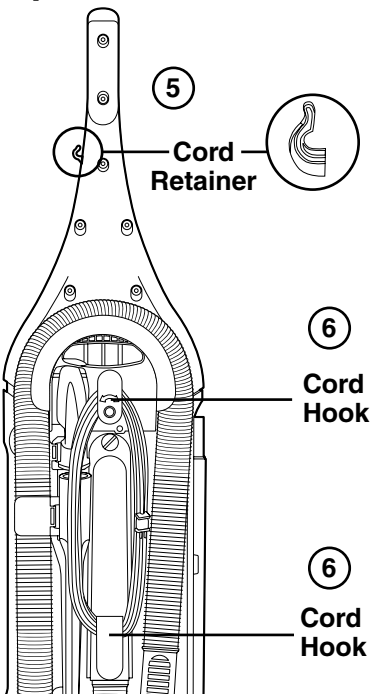

5. You will find your cord retainer on the handle above the upper cord hook. Firmly push the electrical cord down into the cord retainer. This will place the cord out of the way the next time you vacuum.
6. Next, wind the cord around the two cord hooks on the back of the cleaner.
6. Secure the plug to the cord to prevent unwinding.

# How To Use

**CAUTION:** Do not plug in cleaner until you understand all controls and features.

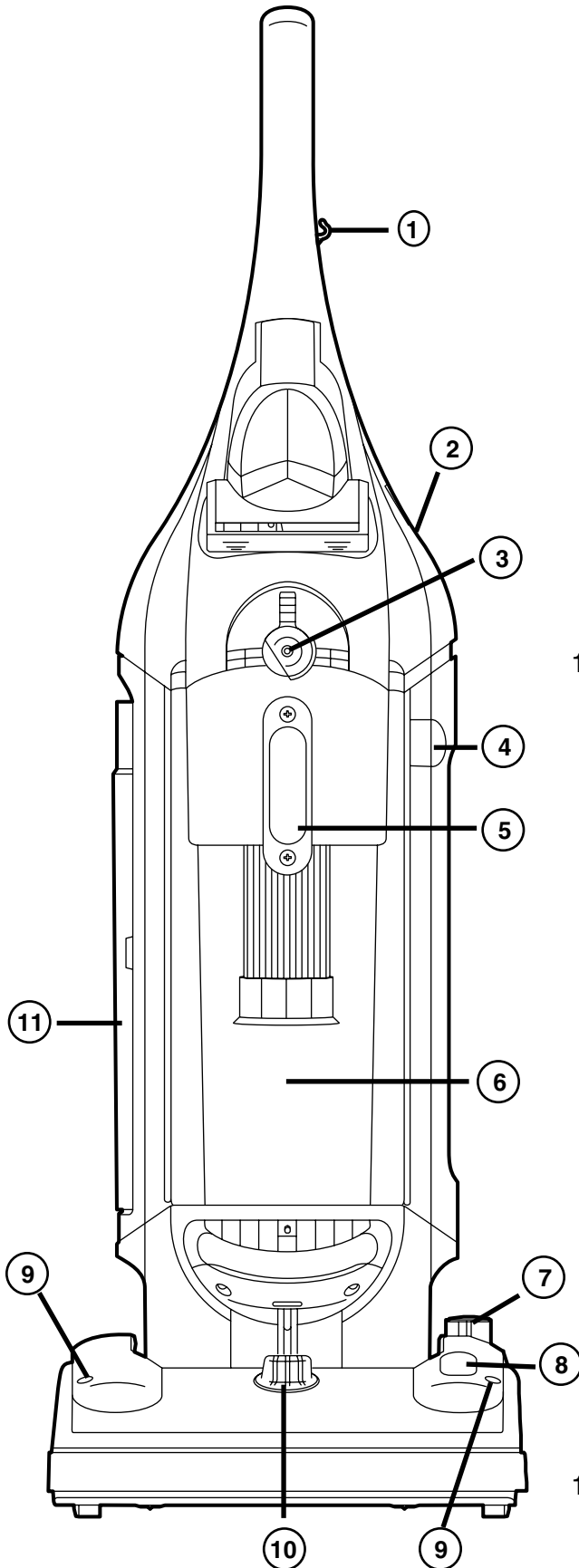

1. **Cord Retainer.** To use, push electrical cord down into cord retainer.
2. **ON/OFF Switch.** International symbol **I** means On, International symbol **O** means Off.
3. **Dust Cup Latch.** When dust cup latch is pointing to the left, the dust cup compartment is unlocked. When dust cup latch is pointing to the right the dust cup is locked in place. See the locked/unlocked symbols on the unit.
4. **HEPA/Micron Filter Compartment.** For removal of HEPA/Micron Filter, depress latch at top of exhaust grill. When refitting grill press firmly to engage latch correctly.
5. **Dust Cup Handle.** Use the handle to remove and replace the dust cup in the dust cup compartment.
6. **Dust Cup Compartment.** To open, turn dust cup latch (3) to the left pointing to unlock symbol, then grasp dust cup handle (5) and pull dust cup out and away from unit. To close, place the front of the bottom of the dust cup in groove at the bottom of dust cup compartment, rotating dust cup up and against unit. Then turn dust cup latch to the right pointing to the lock symbol.
7. **Handle Release.** Step on handle release. Pull handle back to a comfortable position. Press release again to lower handle further to clean under furniture.
8. **Brush Roll Belt Window.** To check condition of belt watch to see if white dots on belt are moving through the window. This indicates the brush roll is turning.
9. **Screws to Release Hood.** Remove these screws to release hood and give access to brush roll belt area.
10. **Floor Type Selector.** The base of the cleaner has an adjustment that raises or lowers the cleaning head to match the type of floor surface. With the cleaner cord unplugged, the height adjustment knob should be rotated to the desired position. For ease in moving the adjustment knob, place the handle in the upright parked position and tilt the cleaner back to remove weight from the front wheels. If you have long pile carpet, set the knob to the highest setting marked 'Long Pile'. For short pile carpets set the knob to the lowest setting which is marked 'Short Pile'. If the cleaner is difficult to push, rotate the adjustment knob to the next highest setting until the cleaner is comfortable to push. The brush roll must reach the carpet for effective cleaning.  
For use on hard floors, care must be taken to avoid damage to the flooring caused by repeated contact from the brush roll. Therefore, do not set on the 'Short Pile' setting, but in the mid point setting between 'Short Pile' and 'Long Pile'.  
For above the floor cleaning using the tools supplied, turn to the 'Tools' setting. The cleaner should be in the upright parked position to avoid repeated contact of the brush roll with the floor surface.
11. **Extension Wands.** Use these wands on the end of the hose for added cleaning reach.

**WARNING:** Avoid injury. Keep loose clothing, hair, fingers, and all other parts of body away from any moving part (such as the revolving brush). Turn off the switch and unplug the cleaner before changing the cleaner height setting.

# How To Use (continued)

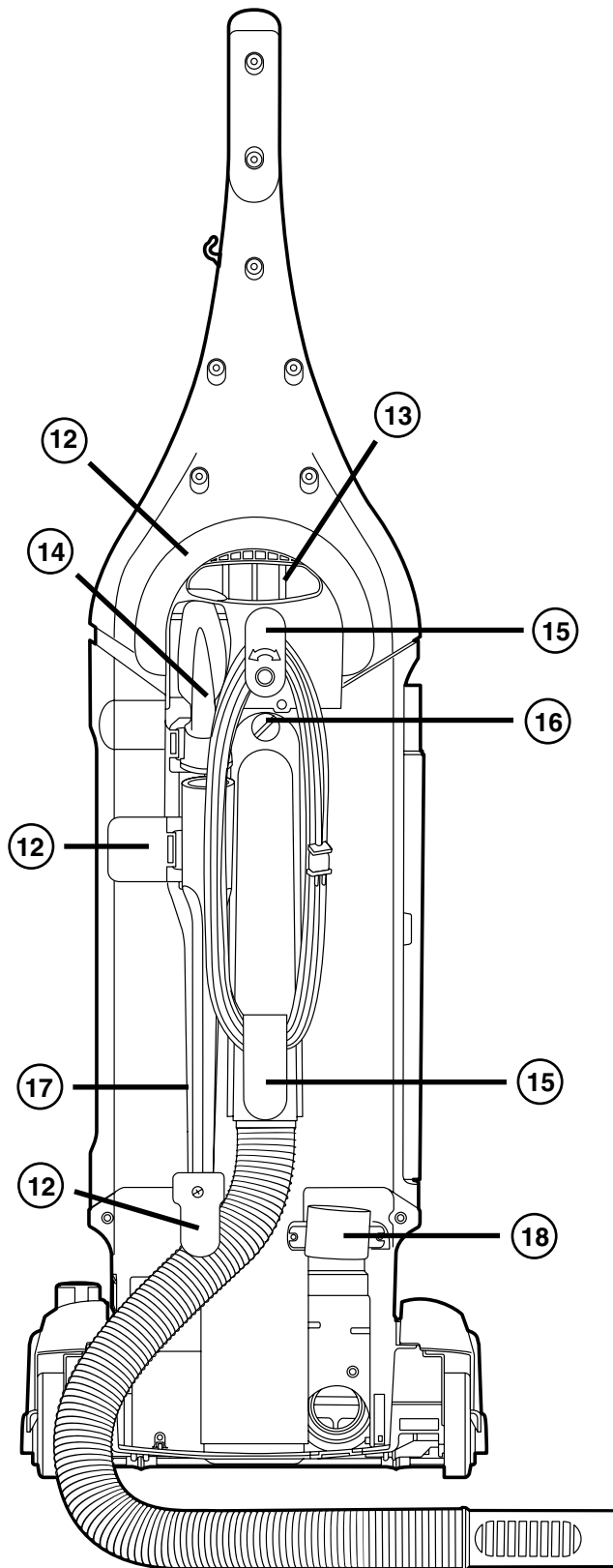

12. **Hose Retainers.** Place hose on retainers to store hose on unit.
13. **Carrying Handle.** Use this handle to carry unit from one place to another.
14. **Dusting/Upholstery Brush.** Store dusting brush here.
15. **Electrical Cord Hooks.** Wrap electrical cord around them to store electrical cord on unit. Top hook rotates down for quick release of the electrical cord. Rotate back up to store electrical cord.
16. **Clear Tube Quarter Turn Fastener.** Turn this fastener to the unlock position to remove the clear tube. To replace tube, place tube on the back of the unit and turn fastener to lock position.
17. **Crevice Tool.** Store crevice tool here.
18. **Hose Adapter.** Place the end of the hose into hose adapter for floor/carpet cleaning.

---

## Thermal Cut Off

This cleaner has a special thermostat that protects the cleaner in case of motor overheating. If the cleaner suddenly turns off, follow this procedure:

1. Push on/off switch to off.
2. Unplug cleaner.
3. Check for source of overheating problem (i.e. full dust cup, clogged hose or clogged filters).
4. If a full dust cup, clogged hose or clogged filters are found, empty the dust cup, unplug the hose or replace the filters.
5. Wait at least 30 minutes before attempting to reuse the cleaner.
6. After 30 minute cool down period, plug the cleaner in and push the switch pedal. The cleaner should turn on.
7. If the cleaner still does not operate, call 08706 055 055 for customer assistance.





# How To Use Accessories

**CAUTION:** Do not place cleaner on furniture or stairs as the brush roll may cause damage. Place cleaner on floor with the handle in storage position while using accessories.

**NOTE:** Do not place cleaner on furniture or steps as the brush roll may cause damage. Place cleaner on floor with the handle in storage position while using accessories.



-  Always work with the cleaner below you, pulling hose from side of cleaner; not the back or the front of the cleaner.
-  NEVER STAND ANY CLEANER ABOVE YOU.
-  NEVER POSITION ANY CLEANER ON THE STAIRS AS THIS COULD DAMAGE THE CARPET.

1. Remove hose from hose adapter on the back of cleaner.
2. Place desired accessory onto end of hose or wand.

**Dusting/Upholstery Brush** is for furniture, blinds, books, lamp shades, shelves, curtains, draperies, cushions and fabrics.

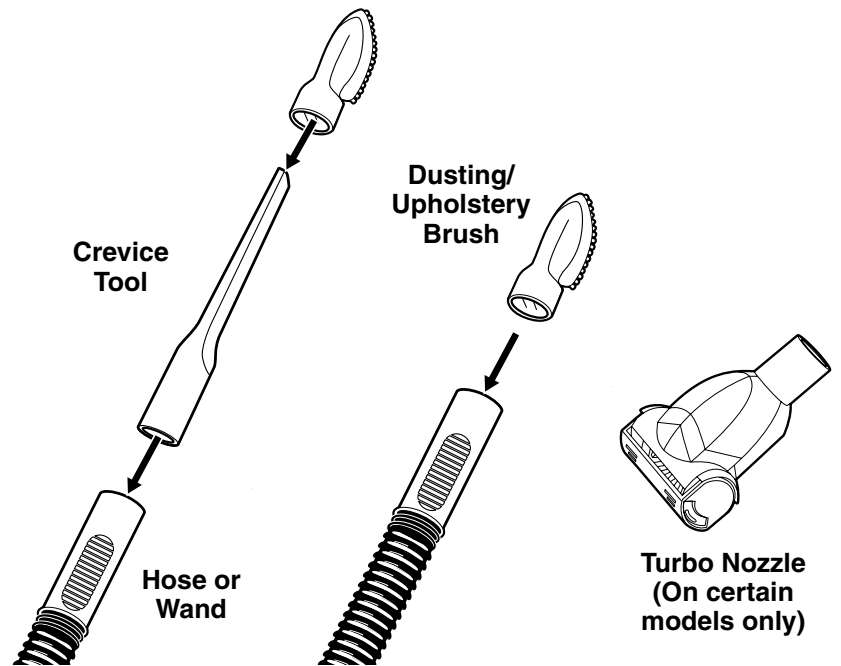
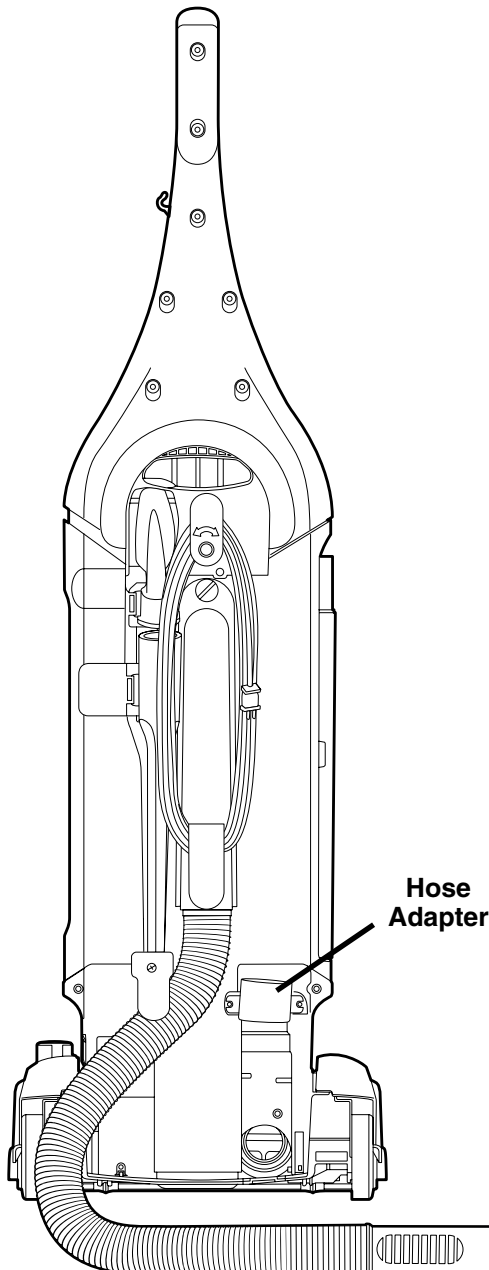

**Crevice Tool** cleans corners, skirting boards, between cushions.

**Turbo Nozzle (On some models)** cleans upholstery and stairs.

**Extension wands** (Some models use 1 wand)

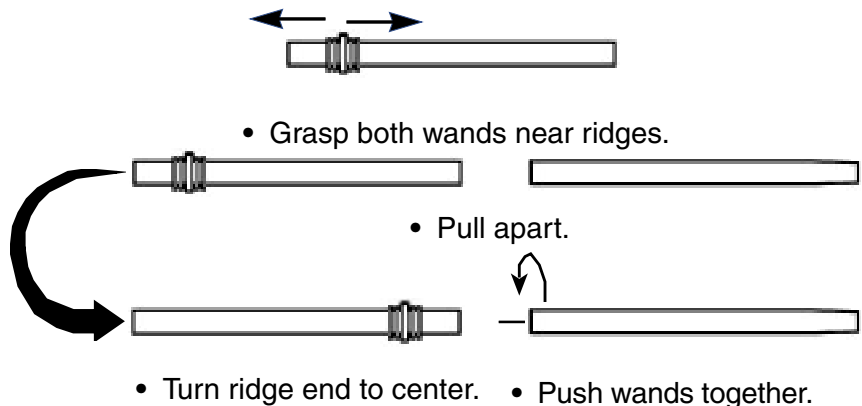

# How to Check and Clear Hose Blockages

Low suction or poor pick-up may be due to a blockage in the vacuum cleaner.

1. Remove hose from hose retainer and check suction at end of hose - if little or no suction, check dust cup. Empty if needed. If no improvement, proceed to step 2.

**CAUTION: Turn off the switch and unplug the electrical cord before clearing hose.**

2. Remove electrical cord from cord hooks. Disconnect the clear tube by turning quarter turn fastener to the right to release, then lift away from cleaner.

Check for any obstructions that may be in the tube. Any obstructions can be removed by using a blunt instrument to clear the tube.

3. To completely release hose from the unit, remove two screws.

Any obstructions can be removed by using a blunt instrument to clear the hose. Flexing the hose may help loosen the blockage.

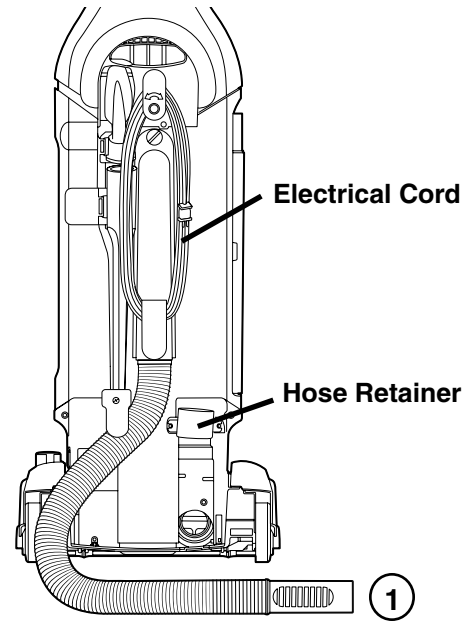

1. Remove hose from hose retainer and check suction at end of hose.

After clearing blockage, reverse above steps to reassemble unit.

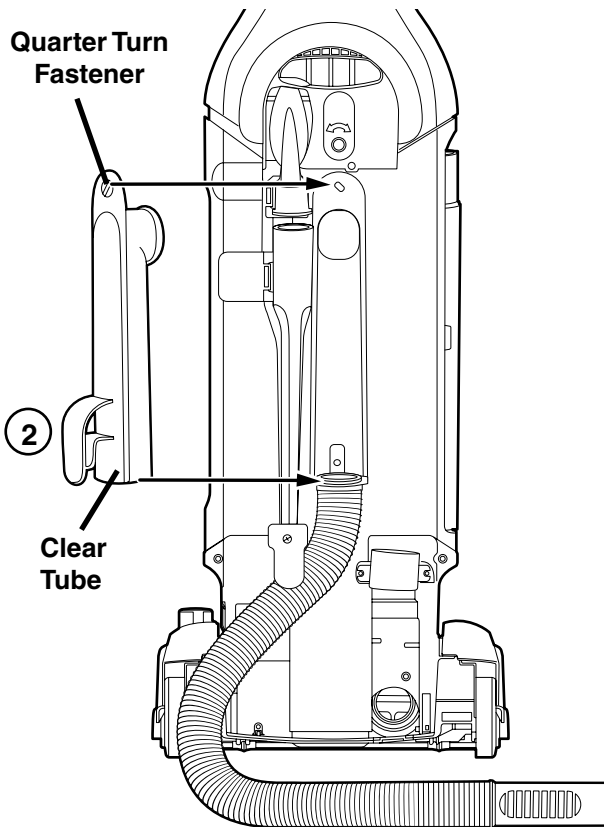

2. Disconnect clear tube.

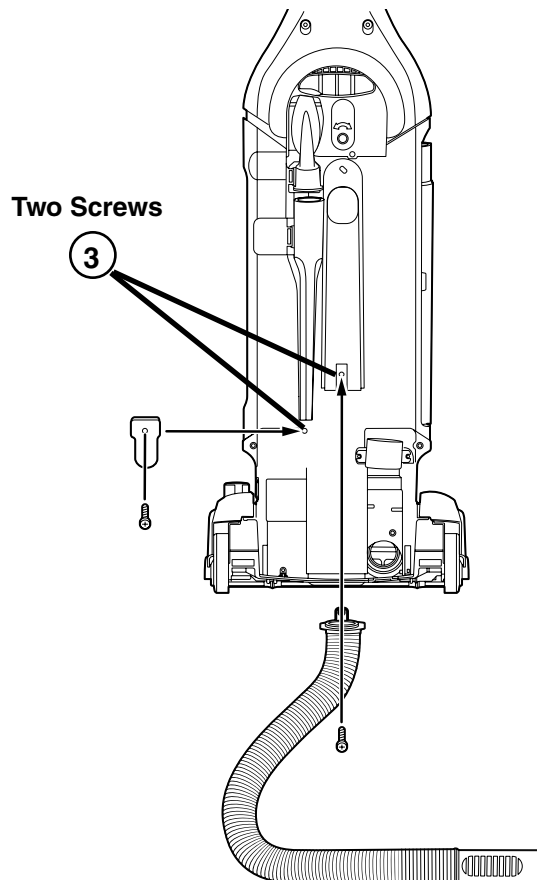

3. Release hose from unit.

# How To Maintain

The instructions in this booklet serve as a guide to routine maintenance. To avoid unnecessary service calls, check the dust cup, belt, and brush roll often.

## Brush Roll

The brush roll turns as it sweeps and combs the carpet pile. Remove hair and threads from the brush roll so it continues brushing the carpet. To maintain the most efficient cleaning, the bristles must touch the carpet. To test the bristle length, hold a ruler against the underneath side of the cleaner. If the bristles no longer touch the ruler, replace the brush roll.

## Brush Roll Belt

The brush roll belt turns the brush roll to agitate, sweep, and comb the carpet pile. Check the belt regularly to be sure it is in good condition. Replace the belt if it stretches, cracks or loses tension. Cut away any hair or threads wound around the brush roll or the belt pulley because the buildup could cause the belt to rotate unevenly.

## How To Replace Brush Roll Belt

**CAUTION:** Turn off the switch and unplug the electrical cord before replacing belt. Belt pulleys can become extremely hot during normal use. To prevent injury, avoid touching the motor pulley when checking the belt.

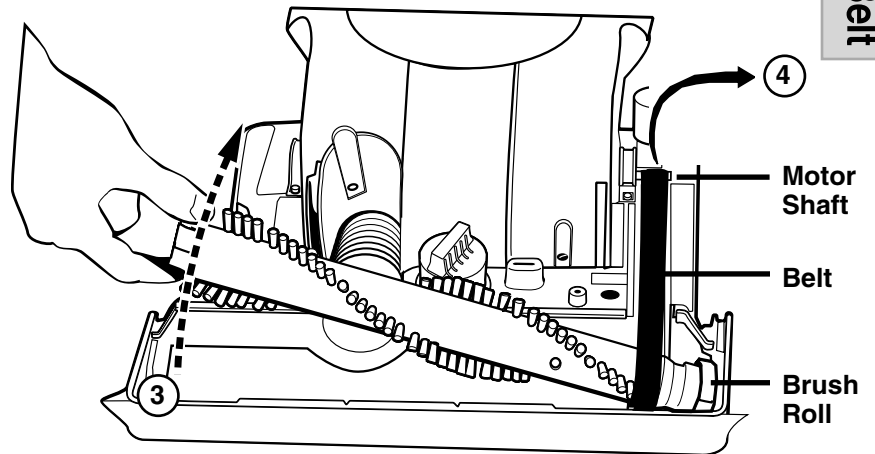
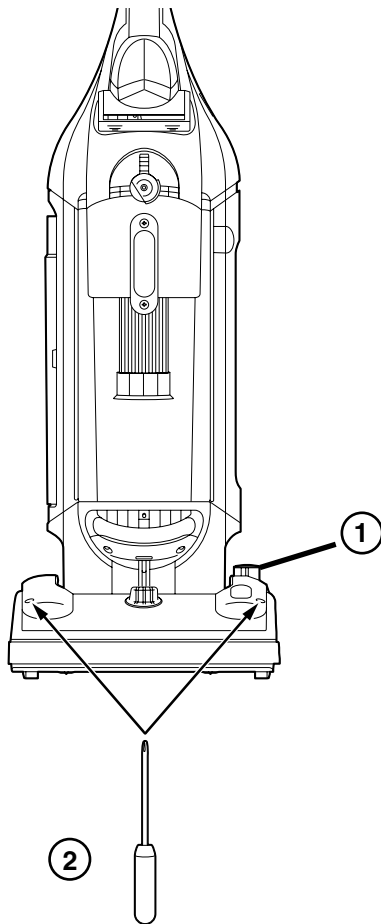

1. Lower handle to floor to change belt.
2. Remove two screws to release hood. Lift hood to remove.
3. Lift left end of brush roll.
4. Remove and discard belt.
5. Clean debris from brush roll area.

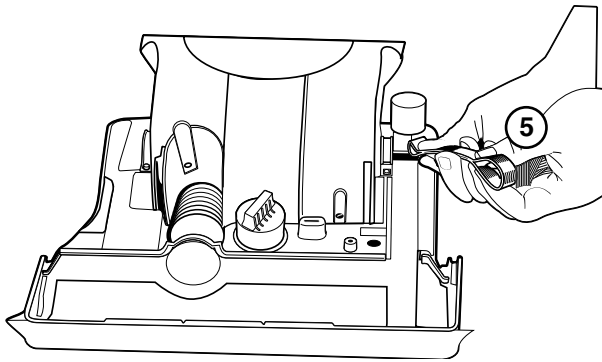

6. Place new belt around motor shaft.

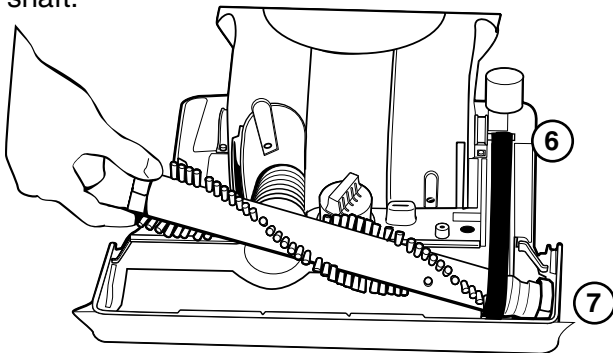

7. Place belt around brush roll pulley.  
8. Pull right side of brush roll to stretch belt. Secure right end cap into base.

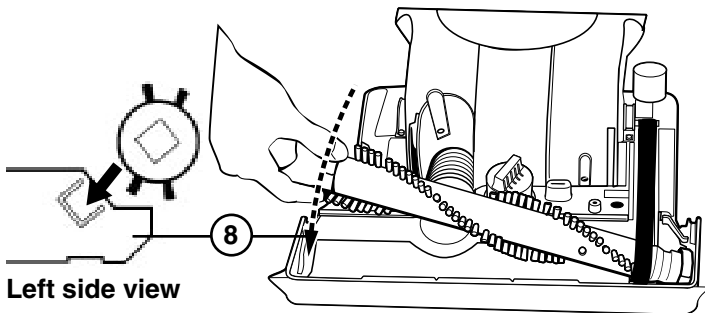

9. Align left end cap with square in base. Push end cap into place; see left side view.

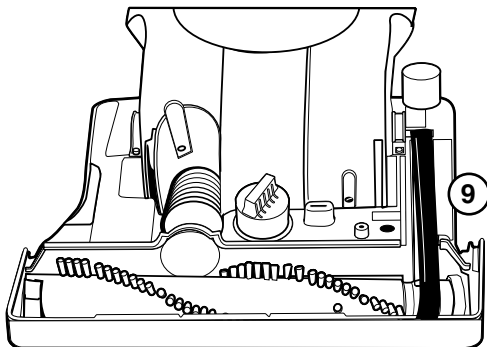

10. Rotate brush roll to seat belt.  
11. Replace the hood. Make sure hood front is behind furniture guard.  
12. Tighten screws.

**To Change Dust Cup Pleated Filter:**

**CAUTION:** Turn off the switch and unplug the electrical cord before changing the Pleated Filter. Never operate the vacuum cleaner without the dust cup or the pleated filter assembly.

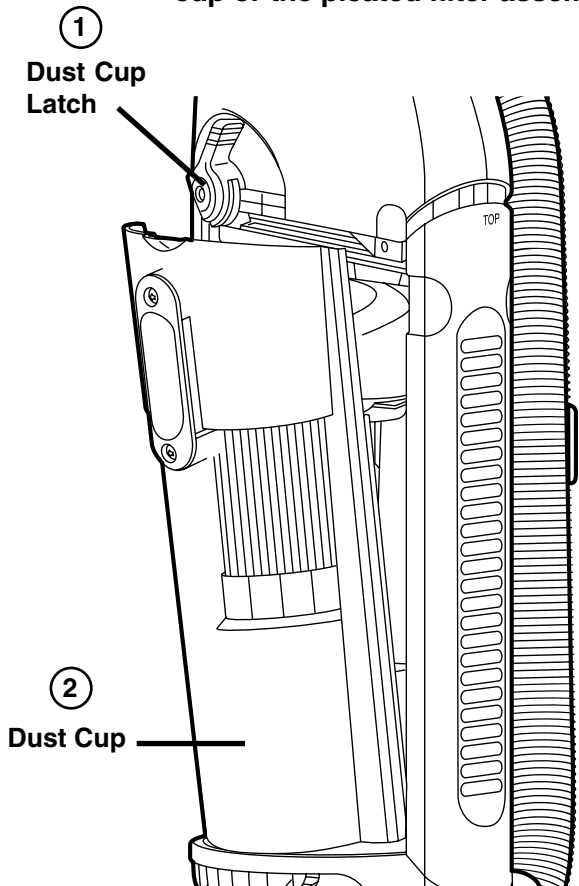

Release dust cup by rotating dust cup latch to the left pointing to the unlock symbol (🔓). Pivot dust cup out and away from cleaner and remove.

Remove cyclonic dust cup by pulling latch (1) forward, pivoting cyclonic dust cup out and lifting up. To replace cyclonic dust cup, put bottom of cyclonic dust cup in place by aligning tabs in slots and pivot top assembly back into place. Push down on latch (1), making certain that latch securely snaps and overlaps tabs at top of dust cup.

To maintain good performance, check and clean the Pleated Filter each time the dust cup is emptied and clean if needed. The filter can be cleaned by washing with mild detergent and warm water. Be sure pleated filter is completely dry before reinstalling.

### To clean the Pleated Filter:

1. Remove the filter assembly by grasping handle and lifting upward and out of the dust cup.
2. Grasp the pleated filter and turn counter clockwise to remove.
3. Lift pleated filter from cone and wash. Shake excess water from filter. **Do not submerge filter assembly – wipe only with a damp cloth.**
4. **When all parts are completely dry**, replace pleated and turn clockwise to lock in place.

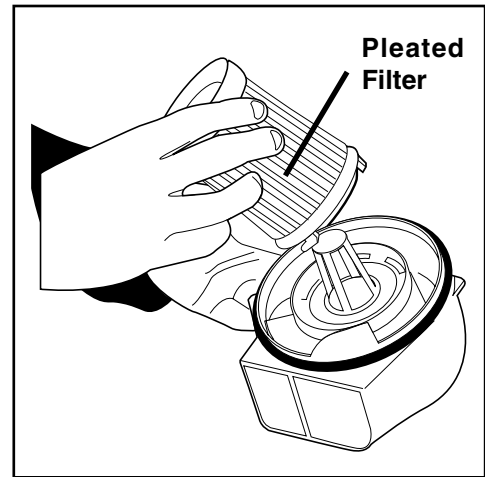
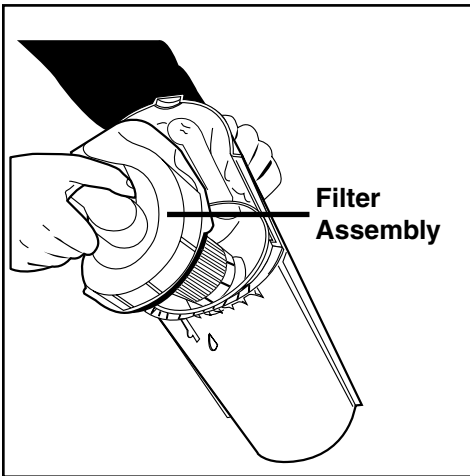

FOR INSTRUCTIONS ON HOW TO REMOVE THE CYCLONIC DUST CUP FROM THE CLEANER BODY, REFER TO PAGE 12.

### Emptying the Cyclonic Dust Cup:

It is clearly visible when the dust compartment is full and needs emptying. Remove dust cup from cleaner body and dump debris in a waste container.

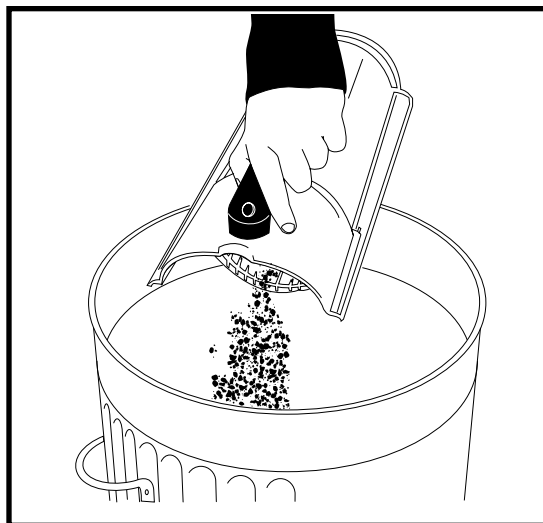

### Reinstalling the Cyclonic Dust Cup:

To mount filter assembly into cleaner body, make certain filter assembly is fully seated in top of dust cup. Replace dust cup by aligning front of the bottom of dust cup into groove on cleaner. Pivot dust cup up against cleaner and rotate the dust cup latch to the right to secure.

**CAUTION:** The dust cup can be washed in warm water, if desired, **but** strong detergents should not be used. Dry thoroughly before using again. **Do not submerge filter assembly, wipe only with a damp cloth.**

**Micron Filter (on certain models only)**

Check the micron filter periodically and change as needed. For maximum efficiency, replace the micron filter twice a year.

**To Replace Micron Filter**

1. Push down on latch and pull out on Micron filter door to remove.
2. Grasp filter and pull out.
3. Place new Micron filter into cleaner.
4. To close, place micron filter door on top of bottom tab, pivot door up and press door against cleaner until it latches.

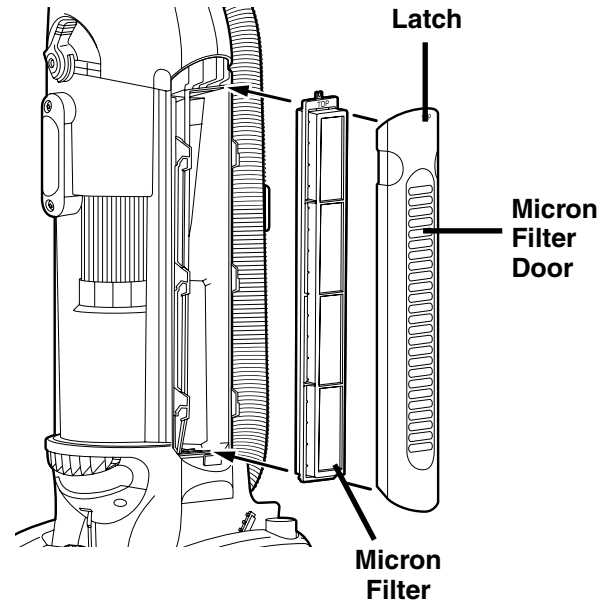

Use ELECTROLUX replacement filters ONLY.

**HEPA Filter (on certain models only)**

Check the HEPA filter periodically and change as needed. For maximum efficiency, replace the HEPA filter twice a year.

**To Replace HEPA Filter**

1. Push down on latch and pull out on HEPA filter door to remove.
2. Grasp filter and pull out.
3. Place new HEPA filter into cleaner.
4. To close, place HEPA filter door on top of bottom tab, pivot door up and press door against cleaner until it latches.

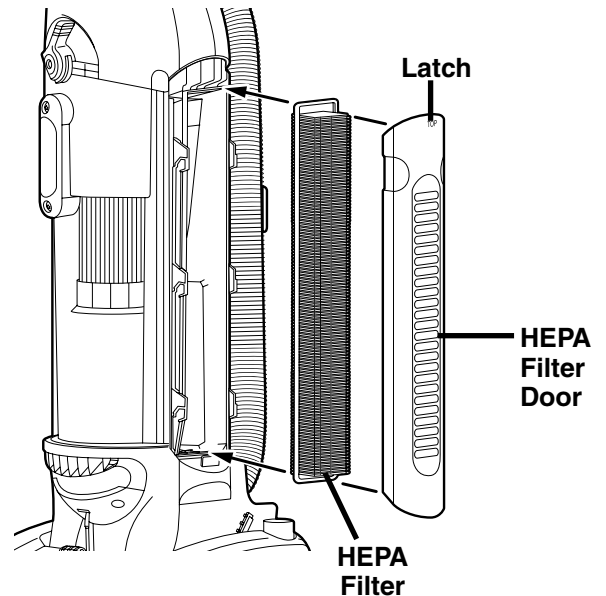

**Riser Visor Turbo Nozzle**

**Maintenance Instructions**

1. To open Turbo Nozzle, unscrew the two (2) screws on the side (as pictured).
2. Lift up the bottom housing.
3. Clear blockage from brushroll area.
4. To close, align top and bottom housings and tighten with the two (2) screws.

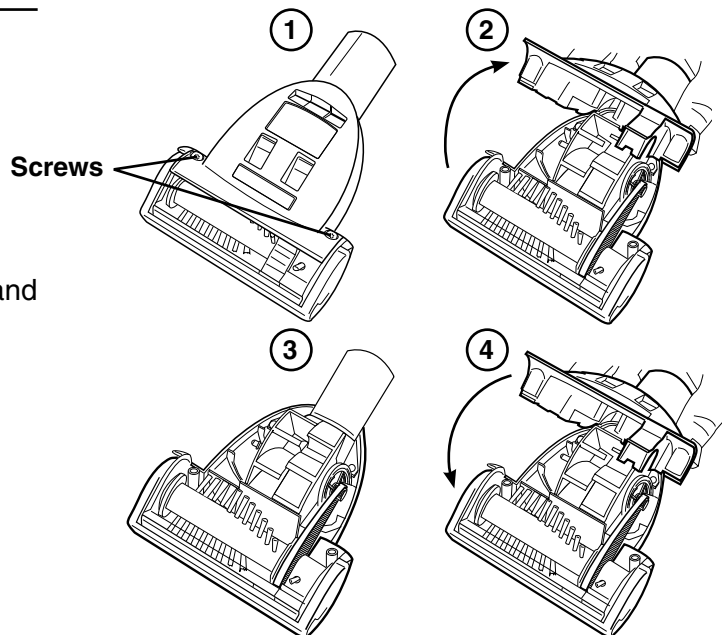

**NOTE:** Turn off the switch and unplug the electrical cord before servicing.

PROBLEM	CAUSE	SOLUTION
Motor will not start.	<input checked="" type="checkbox"/> Electric Plug	<input type="checkbox"/> Push plug securely into outlet. <input type="checkbox"/> Try another outlet. <input type="checkbox"/> Check circuit breaker.
Motor suddenly stops.	<input checked="" type="checkbox"/> Thermal Cut Off	<input type="checkbox"/> Refer to page 8.
Does not clean the carpet or floor.	<input checked="" type="checkbox"/> Filter(s)  <input checked="" type="checkbox"/> Belt <input checked="" type="checkbox"/> Brush Roll  <input checked="" type="checkbox"/> Hose	<input type="checkbox"/> Change the filter. <b>Hint:</b> If picking up fine dust, the filter may <u>not</u> look full, but a fine substance tends to reduce suction when it blocks the airflow through the filter(s) Make sure the filter is installed properly. Make sure filter cover is installed properly. <input type="checkbox"/> Replace a cut, loose or out of shape belt. <input type="checkbox"/> Clean hair and thread from bristles and end cap area. Replace brush roll if bristles are worn. <input type="checkbox"/> Remove any clogs from the hose that restrict the airflow.
No suction at the end of the hose.	<input checked="" type="checkbox"/> Hose	<input type="checkbox"/> Remove any clogs from the hose that restrict the airflow. Check both ends of the hose. (See page 10)
Noise from the brush roll area.	<input checked="" type="checkbox"/> Brush Roll <input checked="" type="checkbox"/> Belt	<input type="checkbox"/> Remove hood and clean debris from the brush roll area. <input type="checkbox"/> Replace a cut, loose or out of shape belt.
Cleaner is hard to push.	<input checked="" type="checkbox"/> Cleaner Height Setting  <input checked="" type="checkbox"/> Belt	<input type="checkbox"/> Turn adjustment knob to a higher position. <b>Hint:</b> Put handle in operating position. Tilt the cleaner back to raise the front wheels off floor. Then turn the knob. <input type="checkbox"/> Replace a cut, loose and out of shape belt.
Brush roll will not turn.	<input checked="" type="checkbox"/> Brush Roll <input checked="" type="checkbox"/> Belt	<input type="checkbox"/> Remove hood and clean debris from the brush roll area. <input type="checkbox"/> Replace cut, loose or out of shape belt.
Burning smell.	<input checked="" type="checkbox"/> Brush Roll <input checked="" type="checkbox"/> Belt	<input type="checkbox"/> Remove hood and clean debris from the brush roll area. <input type="checkbox"/> Replace cut, loose or out of shape belt.
Cleaning height knob will not turn.	<input checked="" type="checkbox"/> Cleaner Height Setting	<input type="checkbox"/> <b>Hint:</b> Put handle in operating position. Tilt the cleaner back to raise the front wheels off floor. Then turn the knob.
Missing parts	<input checked="" type="checkbox"/>	<input type="checkbox"/> Call Electrolux Customer Services on 08706 055055.
Questions?	<input checked="" type="checkbox"/>	<input type="checkbox"/> Call Electrolux on 08706 055055. Have the model and serial numbers ready when you call. See rating plate beneath the cleaner.

**Problem Solving**

**Questions?**  
**Do Not Return To Store**  
**Call Electrolux Customer Services**  
**08706 055055**

---

## **Accessory Items in This Carton**

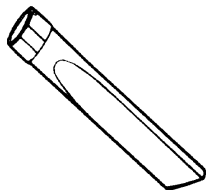

**1 crevice tool**



**1 dusting/  
upholstery brush**



**1 nesting wand**

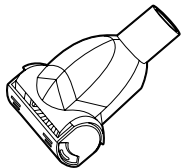

**Turbo Nozzle**



**1 hardware  
package (2 screws)**

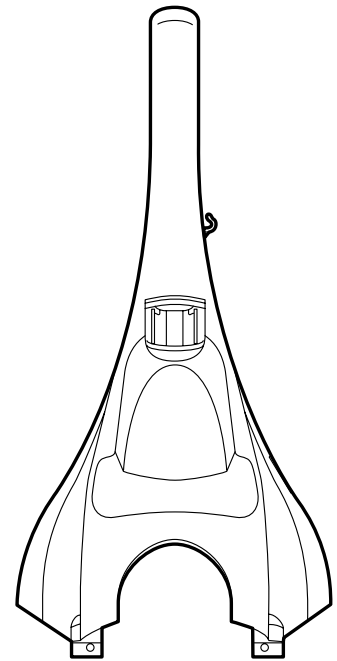

**1 vacuum  
cleaner handle**

---

**Thank you for purchasing  
an Electrolux cleaner.**

**Don't Forget to Use  
Genuine Electrolux Belts**

Caution: Damages caused by the use of non-genuine parts are not covered by the Electrolux Guarantee.